



TOTAL WEIGHING SOLUTION™

Label Printing Scale

Installation Guide

CL8000

B/U/SU Type

User is responsible for any anomalies arising from using the product without reading this guide.



CAS

Thank you for your purchase.

For the proper using & maintaining the scale please read this instruction completely before operating.

Contents

Precautions4

Introduction6

Specifications7

Dimensions9

Setup 11

 1. Basic Setup 11

 2. Installation of the Label Roll 13





 3. Power On/Off..... 17

Troubleshooting.....20

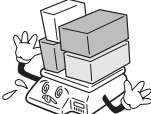

Warning

Precautions when installing the scale. To ensure that you get the most from your scale, please follow these instruction.

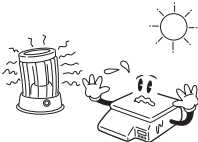
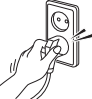
| | |
|---|--|
|  | <p>Do not disassemble the scale.</p> <p>When any damage or defect occurs, contact your CAS authorized dealer immediately for proper repair.</p> |
|  | <p>Do not overload beyond the maximum weight limit.</p> |
|  | <p>Scale must be grounded to minimize electricity static.</p> <p>This will minimize defect or electric shock.</p> |
|  | <p>Do not pull the plug by its cord when unplugging.</p> <p>Damaged cord could cause electric shock or fire.</p> |
|  | <p>To prevent from fire occurring, Do not place or use the scale near flammable or corrosive gas.</p> |
|  | <p>To reduce electric shock or incorrect reading, Do not spill water on the scale or place it in humid condition.</p> |
|  | <p>Avoid placing the scale near heater or in direct sunlight.</p> |
|  | <p>Insert plug firmly to wall outlet to prevent electric shock.</p> |

**Attention**

Make sure to plug your scale into the proper power outlet.

For maximum performance, plug into a power outlet 30 minutes before the usage for warm up.

| | |
|--|---|
| | <p>For consistent and accurate reading, maintain periodical check by your CAS authorized dealer.</p> |
| | <p>Avoid sudden shock to the scale.</p> |
| | <p>Grab on the bottom of the scale when moving.</p> |
| | <p>Keep the scale away from other electromagnetic generating devices. This may interfere with accurate reading.</p> |
| | <p>Place the scale on firm and temperature consistent environment.</p> |
| | <p>By adjusting 4 corners of the scale, set the scale even using the built in scale leveling indicator.</p> |

Introduction

Thank you for purchasing CAS CL8000 series.

CL8000 is a PC-based price computing electronic scale. We have integrated intuitive and powerful functionalities in its design to address the needs of users in various applications, and we are confident that CL8000 will make operating your business easier.

Remember, for proper installation and maintenance please have your CAS authorized dealer do the primary installation, programming, and demonstration. Your CAS authorized dealer also has a wide variety of supplies, accessories, and expansion options for whatever your new and increasing demands may require. Authorized CAS dealers are trained to help you with every aspect of the CL8000 series and should you need servicing, they are highly trained by CAS to assist you with virtually any problem.

● Included Accessories

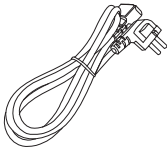

Power Cable



Installation Guide

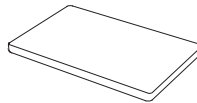

Load Tray



GND Wire

Specifications

| | | | |
|---------------------|---|----------|-----------|
| Max. Capacity | 3/6 kg | 6/15 kg | 15/30 kg |
| Interval | 1/2 g | 2/5 g | 5/10 g |
| Max. Tare | -2.999 kg | -5.998kg | -9.995 kg |
| A/D Conversion Rate | Approx. 8 times/s | | |
| Measurement Type | Load cell | | |
| Operating Temp. | -10°C ~ 40°C (14°F ~ 104°F) | | |
| Power | AC 100~240V 50/60Hz 1.5A | | |
| Printing Rate | Max. 150 mm/s | | |
| Printing Resolution | 202 dpi | | |
| Label Size | Width: 40 mm ~ 60 mm / Length: 30 mm ~ 200 mm | | |
| Printer Type | Direct thermal print | | |

• System

| | |
|---------------|---|
| CPU | Intel® Celeron™ J1900 (2.0 GHz) Quad-Core Processor / Fanless (Standard) |
| Chipset | Intel® Bay Trail |
| Storage | mSATA SSD 64GB |
| System Memory | 4GB Standard (Type: DDR3L, Socket 1 x SODIMM) |
| Graphics | Integrated Intel HD Graphics |
| Sound | Realtek ALC662-VD 5.1 CH Audio |

• Display

| | |
|------------|--|
| Size/Type | 10.1" TFT LED Backlight, 7" TFT LED Backlight |
| Resolution | 1,024 x 600 |
| Brightness | 10.1" : 180 cd/m ² (typ.), 7" : 350 cd/m ² (typ.), |

● Touchscreen

| | |
|-----------|-----------------------------|
| Type | Projective capacitive touch |
| Interface | USB interface |

● I/O Interface

| | |
|----------------|--|
| USB Ports | 6 (USB 3.0 x 1 / USB 2.0 x 5) |
| Parallel Ports | 2(COM1, COM4 full signal) |
| | 1(COM 3 with 5V/12V power output on 9 pins, factory setting) |
| LAN | 1 x 100 Megabit ethernet, RJ-45 |
| Audio Out | Line-in, Line-out |
| Power | AC 100~240V 50/60Hz 1.5A |
| OS | Windows 10 |

● Instrument & Environment

| | |
|----------------|--|
| Color | Dark gray |
| Load Tray Size | 368 x 288 (mm) |
| 크기 (W x H x D) | B-Type : 399(W) x 450(D) x 171(H)(mm) U-Type : 399(W) x 485(D) x 578(H)(mm) SU-Type : 399(W) x 485(D) x 292(H)(mm) * Height: excluding rear LCD |

Note: Some of the specifications may change without prior notice.

Dimensions

• B-TYPE

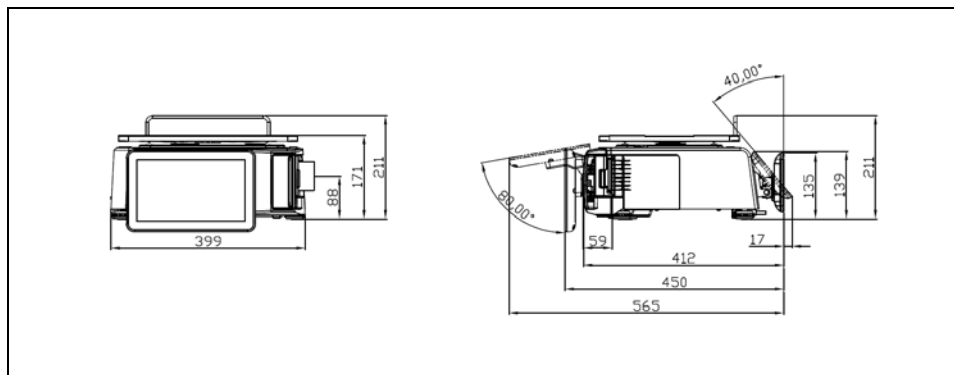

• U-TYPE

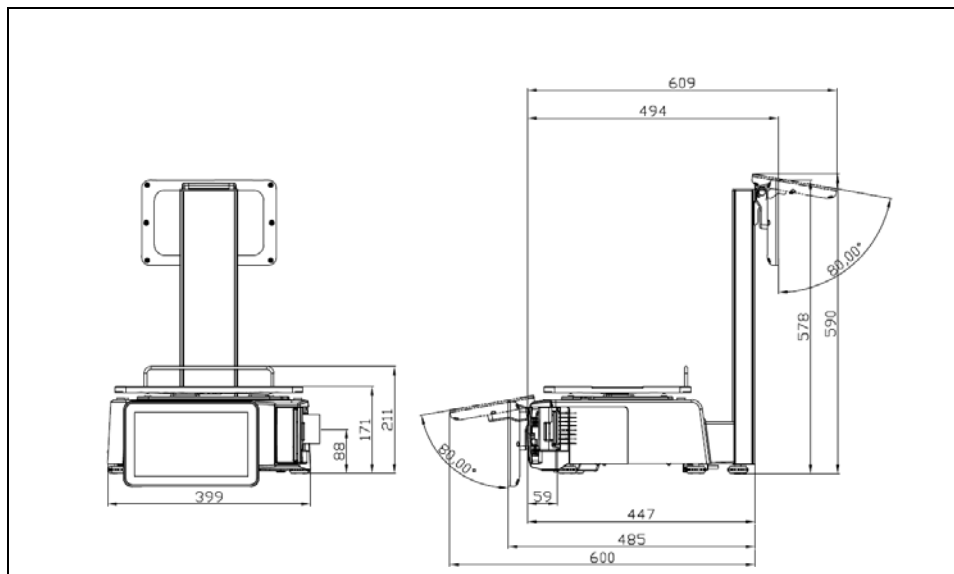

● **SU-TYPE**

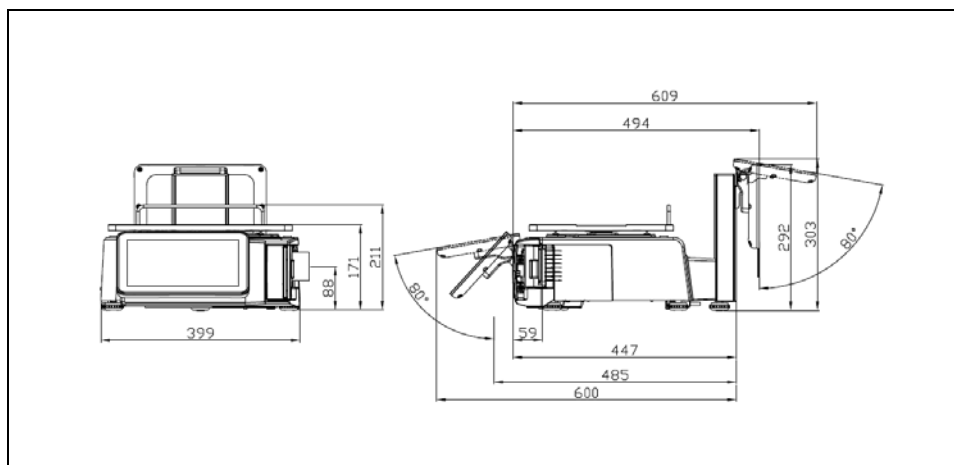

Setup

1. Basic Setup

- B-TYPE

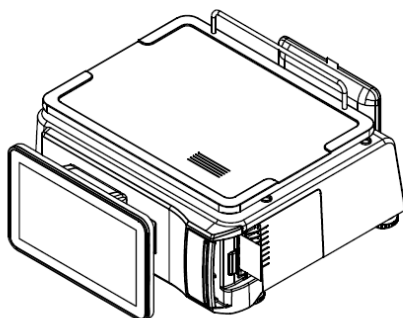

● **U-TYPE**

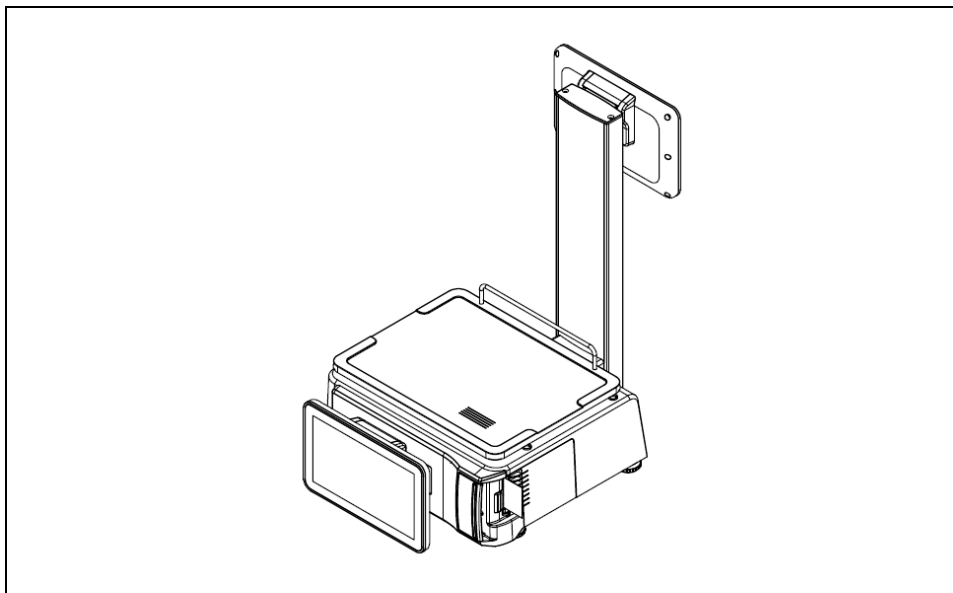

● **SU-TYPE**

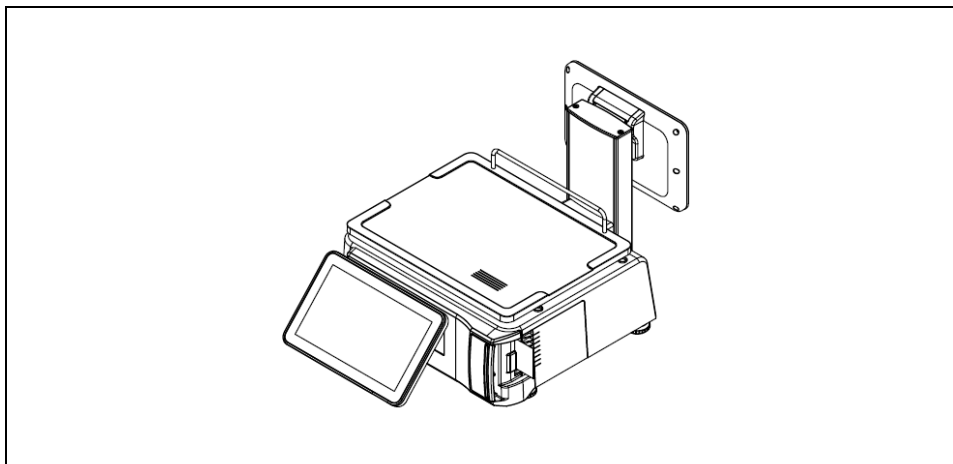

2. Installation of the Label Roll

● Label Specifications

Outer Diameter: 100mm

Inner Diameter: 40mm

Receipt Roll Width: 40, 50, 60mm

Label Roll Width: 64mm (max.)

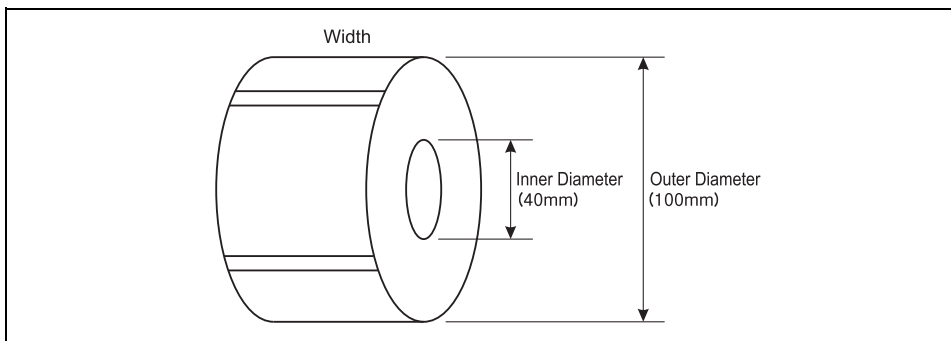

● Printable Area

Label Width: 56mm (max.)

Label Length: 200m (max.)

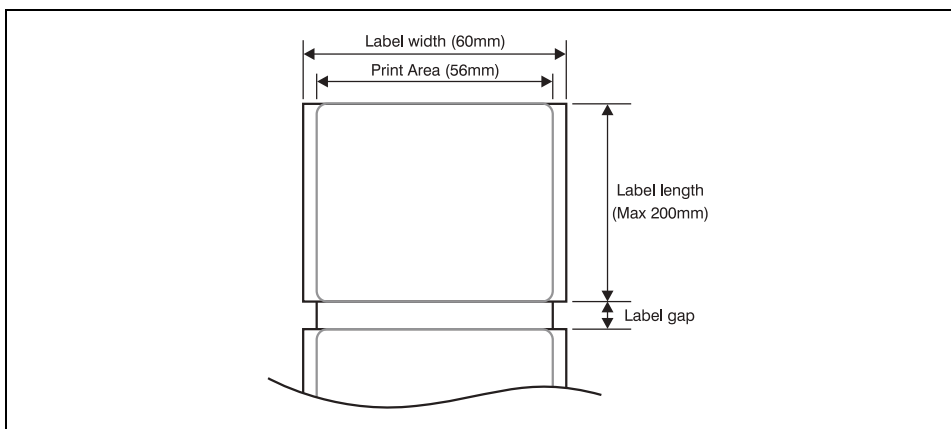

- Please install the label roll in the following order:

1) Pull the front handle to open the front door.

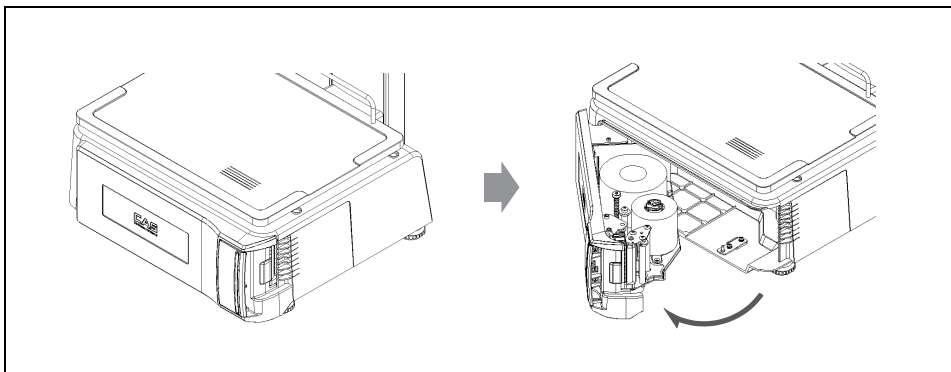

2) Insert the roll into the label supplier pole, then mount the roll.

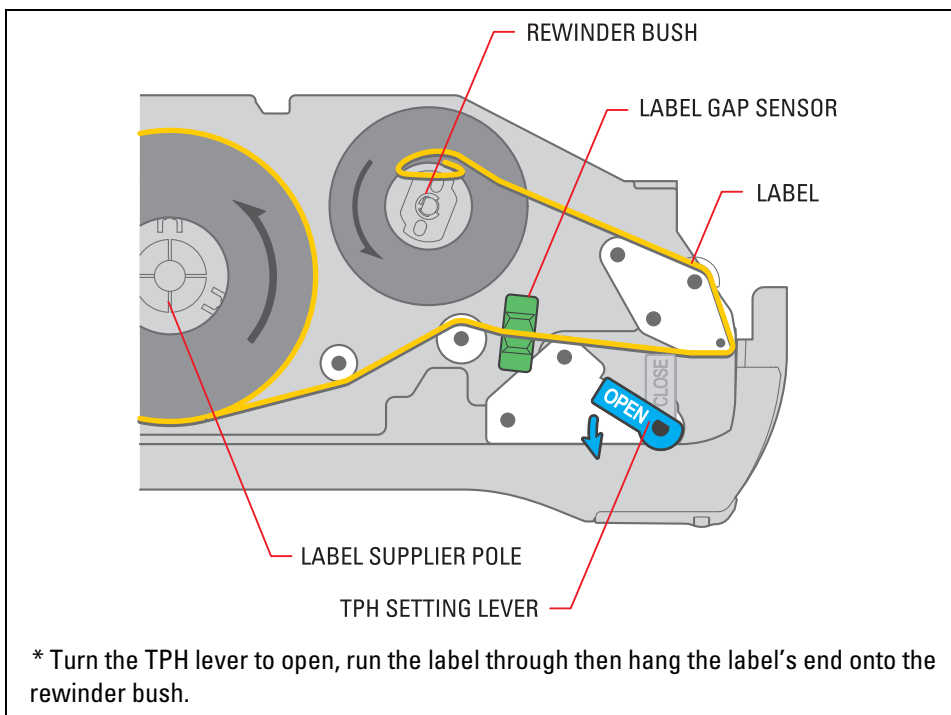

* Turn the TPH lever to open, run the label through then hang the label's end onto the rewinder bush.

3) Hang the label's end onto the rewinder bush, then rotate the level to tighten the label.

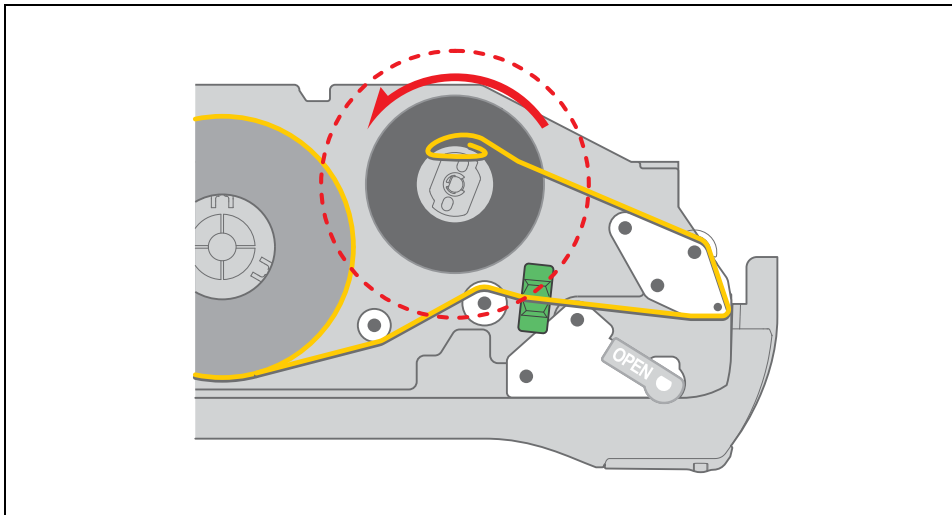

4) Return TPH setting lever to its original position then close the door.

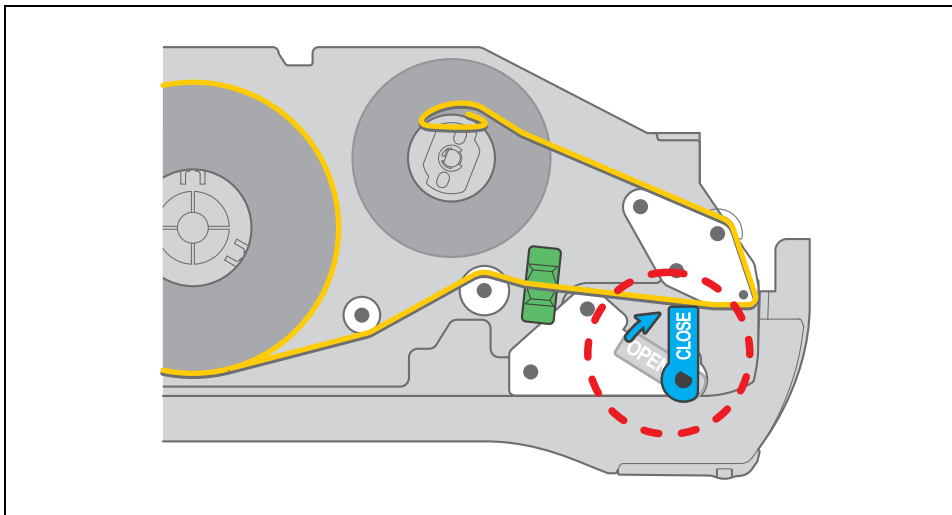

5) Adjust the label (see below), then pull the TPH down.

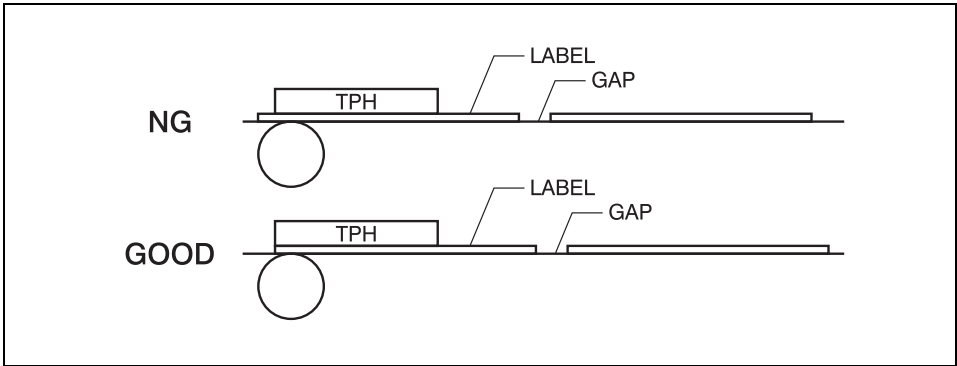

6) Press "Feed" Key.

- If the label is out of position, please check the following:

- a. Set the label size
- b. Adjust the roll position
- c. Set the sensor

3. Power On/Off

1) Booting

1. Turn on the switch on the lower side of the scale.

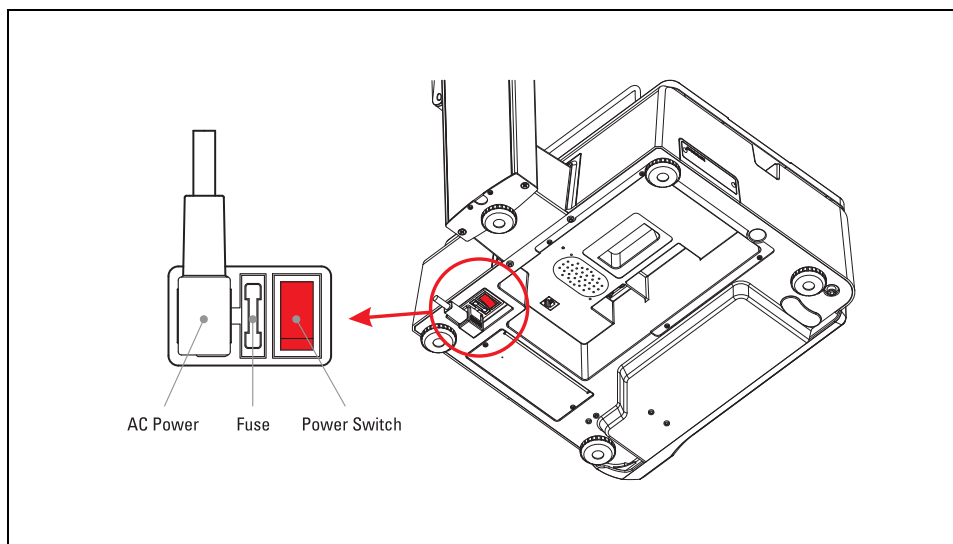

2. Check to see if the windows have booted up normally.

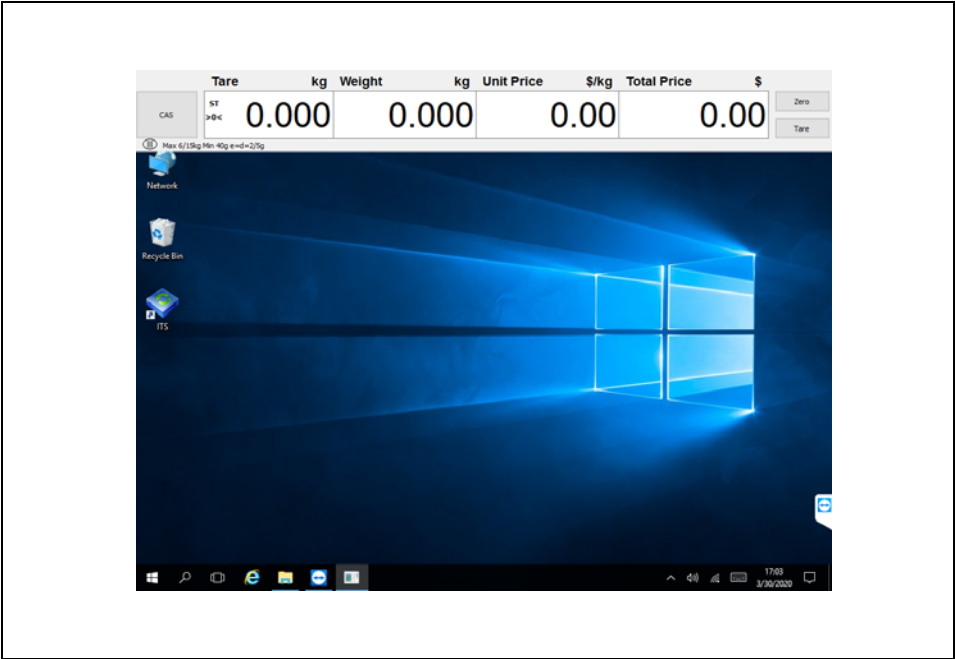

Once booted normally, the windows display “Tare/Weight/Unit Price/Price” on the upper side of the screen.

1) Shutting Down

It is recommended that the windows is shut down from the O/S menu for system stability. Please close all applications before shutting down the windows.

- ① Click the "Start" button, then select the Power button.
- ② Click "Shut down" to shut down the windows.

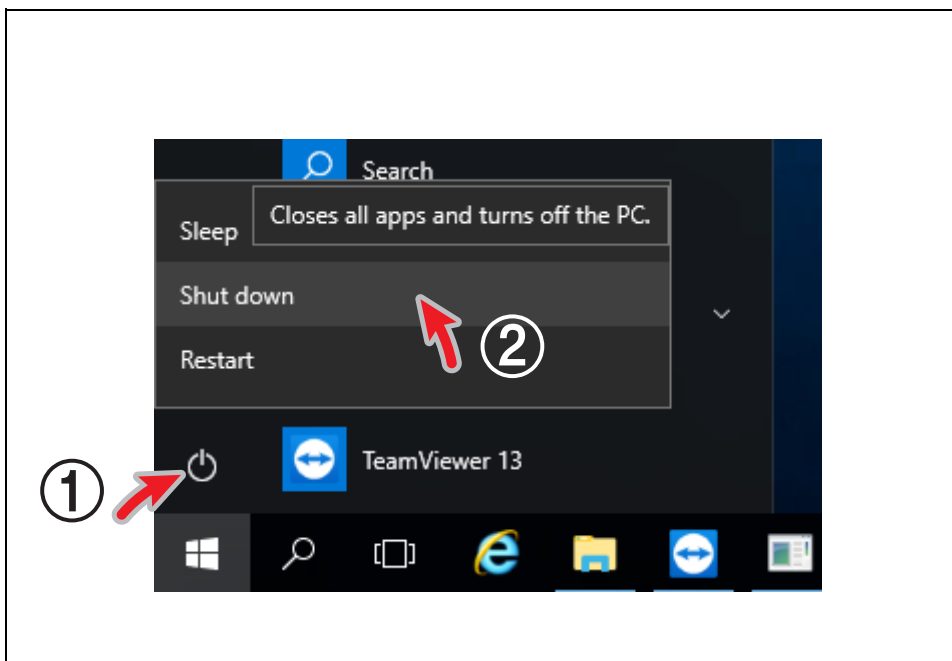

Troubleshooting

1. Communications Issue

| Symptom | Troubleshoot |
|----------------------|---|
| Can't access the LAN | <ul style="list-style-type: none">▪ Check the hub or the switch▪ Check the RJ45 network cable▪ Check the LAN LED▪ Reinstall the LAN card▪ Replace the mainboard |

2. USB Issues

| Symptom | Troubleshoot |
|------------------------|---|
| USB port does not work | <ul style="list-style-type: none">▪ Check the status of plugged devices in the windows' Device Manager▪ Check USB device status and connectivity▪ Remove and reinstall the USB driver▪ Change the USB device |

3. Display Issues

| Symptom | Troubleshoot |
|-----------------------------|---|
| LED backlight does not work | <ul style="list-style-type: none">▪ Check the display cable▪ Check the inverter cable▪ Replace the inverter cable▪ Replace the display panel |

4. Touchscreen Issues

| Symptom | Troubleshoot |
|--|---|
| Touchscreen does not sense tactile input | <ul style="list-style-type: none">▪ Check the BIOS configuration▪ Check the mainboard and the LCD cable▪ Recheck the BIOS configuration |

5. Power Issues

| Symptom | Troubleshoot |
|--|--|
| System does not load following a sudden shutdown | <ul style="list-style-type: none">▪ Check the A/C cable▪ Check the mainboard power▪ Check the CPU configuration/status▪ Check the system memory configuration▪ Check the power button cable▪ Replace the adapter device |

6. Booting Issues

| Symptom | Troubleshoot |
|--------------------------------|--|
| Reboot during system operation | <ul style="list-style-type: none">▪ Check the SATA cable▪ Check the memory status |

7. Reading Issues

| Symptom | Troubleshoot |
|--------------------------------|---|
| Weight reading does not appear | <ul style="list-style-type: none">▪ Check the RS232C cable▪ Check the installed folder |

MEMO

Label Printing Scale

Installation Guide

CL8000

B/U/SU Type



9005CLH00332

9005-CLH-0033-2 2020.09

CAS BLDG., 1315, YANGJAE-DAERO,
GANGDONG-GU, SEOUL, KOREA

TEL_ 82 2 2225 3500
FAX_ 82 2 475 4668

Specifications are subject to change without notice improvement.

